

YN300 Air

摄像机

Pro LED Video Light

使用说明书

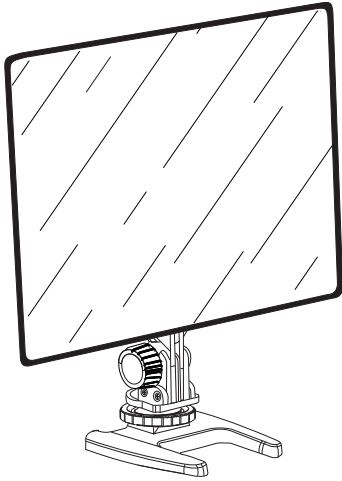

首先感谢您购买永诺YN300 Air摄像机，使用前请认真阅读说明书并妥善保管以便查阅。

YN300 Air采用了我司全新设计的外观，具有超薄、便携、轻便等优点。

一、产品结构

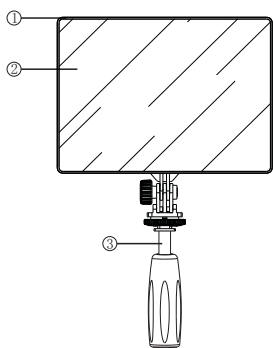

- 1、摄影灯机壳
- 2、柔光板
- 3、手柄
- 4、直流电源插孔
- 5、电池锁扣
- 6、梅花调节螺丝
- 7、热靴固定旋钮
- 8、金属热靴底座
- 9、微型底座
- 10、电量测试按钮
- 11、记忆键
- 12、电源开关/亮度调节旋钮

- 13、LED数码显示屏
- 14、粗/细调切换按钮
- 15、3200K/5500K色温切换按钮

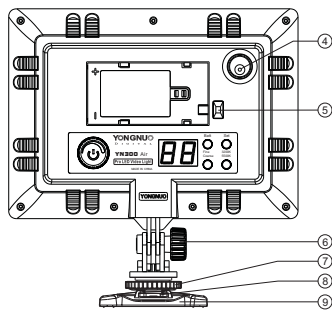
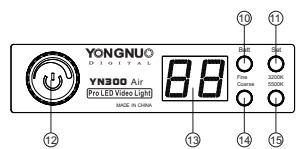

二、功能简介

- 1、首次采用贴片LED光源，灯光柔和、光照角度大，更适合于近距补光。
- 2、YN300 Air采用超高显色指数LED，RA平均值大于95，接近自然光，完美还原被拍摄物的色彩。
- 3、同时支持NP-F系列锂电池和外接8伏5安直流电源。
- 4、采用永诺专门为摄像补光开发的LED恒流驱动技术，拍摄时绝不出现光波纹、频闪、抖动等不良现象。
- 5、采用编码器数字调光，可分粗调、细调模式，调光精准可靠。
- 6、采用LED数字方格显示屏，显示效果更立体，功率输出更直观。
- 7、配置永诺LED摄像机专用手柄，坚固实用。

三、使用方法

- 1、安装电池
 - a、安装锂电池时按箭头方向将电池装入卡槽；

注：建议使用永诺NP-F750电池来获得更持久的拍摄体验，此电池容量高达5200mAh在最高亮度下可持续使用约130分钟，不使用时请取下电池。

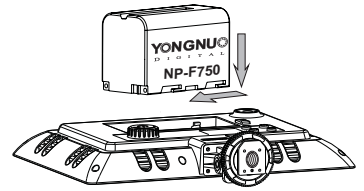

- b、拆卸锂电池时，请先按下电池锁扣再取出锂电池

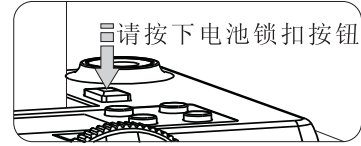

- 2、安装摄像机

先将灯脚通过梅花胶头螺丝固定在摄像机底部，根据您的方向调节摄像灯的角度。

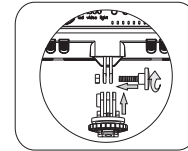

- 3、根据您的需要可以通过以下方式固定摄像机：

- a、固定在单反相机/摄像机热靴上使用。

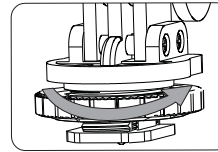

- ①将热靴固定旋钮按箭头方向旋转到顶部

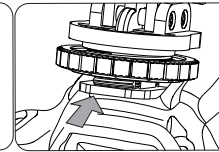

- ②按箭头方向推入相机/摄像机热靴座

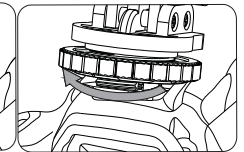

- ③按箭头方向将热靴固定旋钮拧紧

- b、通过附带的微型底座放置在桌面或者其他平面上使用

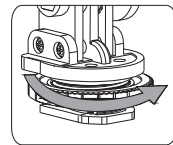

- ①将热靴固定旋钮按箭头方向旋转到顶部

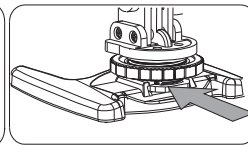

- ②将灯脚金属热靴按箭头方向推入微型底座

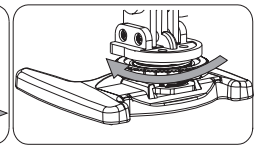

- ③按箭头方向将热靴固定旋钮拧紧

- c、直接固定在三脚架上使用

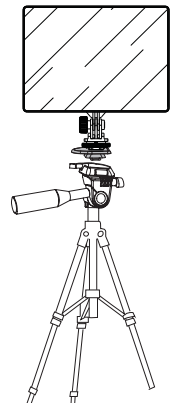
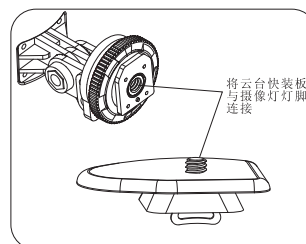
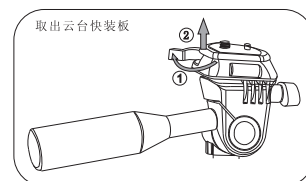

摄像机固定在三脚架上

d、通过附带的手柄手持使用。

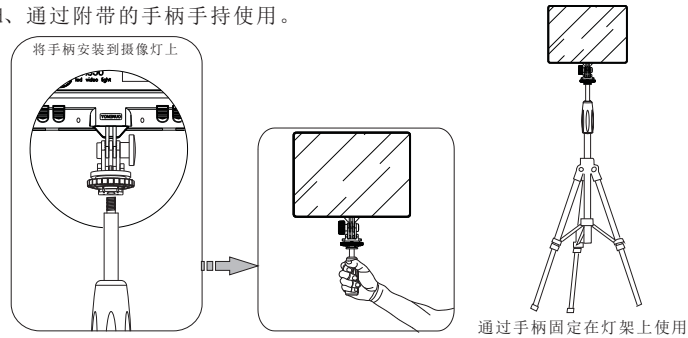

4、开机及亮度调节

a、按下电源开关，LED摄像灯点亮，向右旋转增加亮度，向左旋转减小亮度。

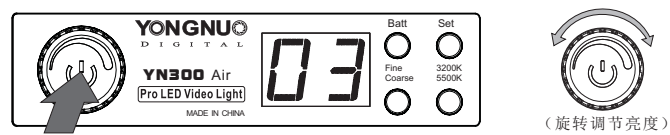

b、Fine/Coarse按钮

可分粗调、细调模式，使用更方便。按下Fine/Coarse按钮进行粗细调的切换当Coarse的指示灯亮起则进入粗调模式亮度按10%为一个调节单位。再按一下此按钮则切换到细调模式Fine指示灯点亮此时亮度按1%为一个调节单位。

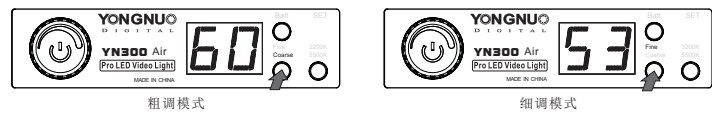

5、色温调节

按下3200K/5500K按钮可以对色温进行切换,通过改变两者之间的亮度比例得到3200K至5500K之间的色温。按下此按钮当指示灯在3200K上点亮时则此时旋转亮度调节旋钮就可以对3200K色温的灯进行调节；再按一下此按钮指示灯切换到5500K上点亮此时旋转亮度调节旋钮就可以对5500K色温的灯进行调节。

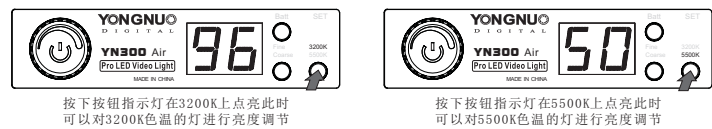

6、电量测试

按下Batt电量测试按钮，此时的读数为电池剩余电量的百分比，电量的读数可分为P0-P9分别就是0%-90%，下图显示读数为P3则相对电量为30%（注：低亮度时测试与高亮度时测试剩余电量是不相同的，测的是当前亮度下，可以使用时间的长短）。



7、记忆键

a、在您认为摄像灯调整到最佳的亮度和色温时，长按SET键，数码管闪烁两次即成功保存设置，当再次调整摄像灯后想要恢复之前的设置只需再次短按SET键。

b、长按SET键直接更新保存设置。



8、外接电源供电

可选配永诺电源适配器，以获得摄像灯的长时间工作。当使用外接电源时，摄像灯将自动切断电池供电且不对电池充电。电源接口为内正外负，输入电压为8伏，电流为5安。
注：如使用其他电源适配器造成的产品故障，不予保修。

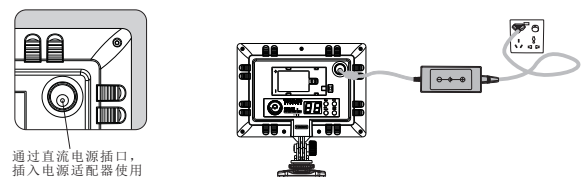

四、产品规格

光源	96颗贴片LED	光照角度	110°
色温	3200K-5500K	显色指数	大于或等于95
输出功率	18瓦	重量	500克
流明值	2000LM	彩盒尺寸	210*175*62毫米
平均寿命	50000小时	电源	1个锂电池或外接8伏5安直流电源
所含物品：摄像灯（1）、手柄（1）、说明书（1）、灯脚（1）、微型底座（1）			
注：如有缺失请与经销商联系			

五、故障分析及排除

在使用过程中，您可能遇到以下问题：

故障	原因	处理方法
打开电源开关完全无反应	电池电量不足	使用新电池或外接电源使用
	电路板损坏	返厂维修
亮度不足，调至最亮仍然很暗	电池电量不足	使用新电池或充电后使用
测试电量不准确，调高亮度时显示低电量，调低亮度后电量又满格了	电池电量测试所指示的是，当前亮度下能使用的时间长短。调高亮度后，需要的电量更多，所使用的时间变短，故电量显示变少了	属于正常现象，无需处理

经 销 商：深圳市永诺摄影器材股份有限公司

地 址：深圳市福田区华强北路赛格科技园2栋5楼B509室

电 话：0755-8376 2448

传 真：0755-8376 2765

网 址：www.hkyongnuo.com

生 产 商：深圳市永诺电器有限公司

地 址：深圳市龙岗区龙岗街道同乐村稳好工业厂区1号厂房

电 话：0755-8480 8443

售后电话：400-0013-888

YN300 Air

Pro LED Video Light

User Manual

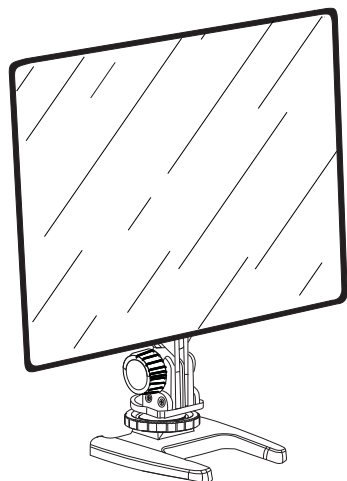

Thank you for purchasing the YN300 Air LED video light, please read the manual carefully before using the product and keep it properly for future reference.

The YN300 Air adopts brand new design, which with the advantage of slim and portable.

I. Product Structure

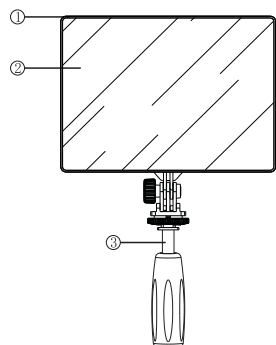

1. Camera case
2. Soft light board
3. Handle
4. DC Power Jack
5. Battery Lock Button
6. Adjusting Screw
7. Hot Shoe Fastening Knob
8. Metal Hot Shoe Base
9. Mini-type Base
10. Electric Quantity Testing Button
11. Memory Button
12. Power Switch/Luminance Adjustment Knob

13. LED Digital Display Screen
14. Coarse/Fine adjusting Switch Button
15. 3200K/5500K Color Temperature Switch Button

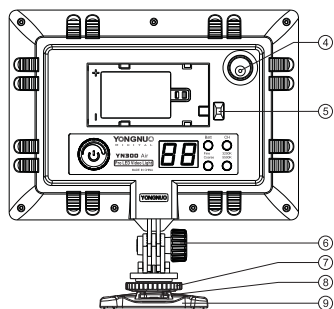
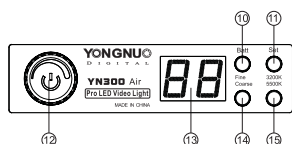

II. Function Introduction

1. YN300 Air video light adopts SMD LED as light source which provides soft light and wide illuminating angle, and it makes YN300 Air video light much suitable for filling light from a close distance.
2. YN300 Air adopts ultrahigh CRI LED. RA average value is greater than 95 and close to natural light, which restores the color of the subject perfectly.
3. YN300 Air supports using NP-F lithium battery or external 8V, 5A DC power.
4. YN300 Air adopts LED constant-current driving technology which is specially developed for light supplement; light ripple, strobing, jitter and other undesirable phenomena can be avoided during the shooting.
5. YN300 Air adopts encoder for digital dimming; it can be divided into coarse tuning mode and fine tuning mode; dimming result is accurate and reliable.
6. YN300 Air adopts LED digital grid display screen, which makes display result more stereoscopic and power output more intuitive.
7. YN300 Air is configured with handle special for LED video light; this special handle is firm and practical.

III. Method of Application

1. Battery Installation

a. Put the lithium battery into the battery compartment in the direction of the arrow.
Note: It is recommended to use YONGNUO NP-F750 battery to get more durable shooting time. The maximum capacity of the battery is 5200mAh. In the highest brightness, it can be used for about 130 minutes. Please remove the batteries when YN300 Air is not in use.

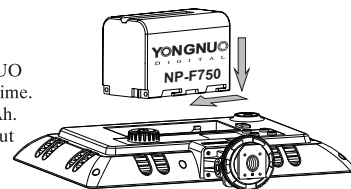

b. When removing the lithium batteries, please press the battery lock and then take out the lithium batteries.

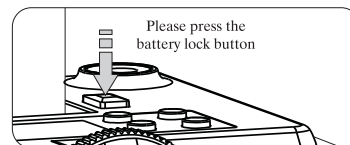

2. Camera Light Installation

Firstly, fasten the lamp base to the bottom of the product with the adjusting screw and then adjusting the angle of the lamp as needed.

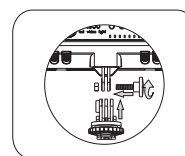

3. The camera lamp can be fastened as the following methods according to your requirement:
a. Fix on the DSLR/Camera hot shoe.

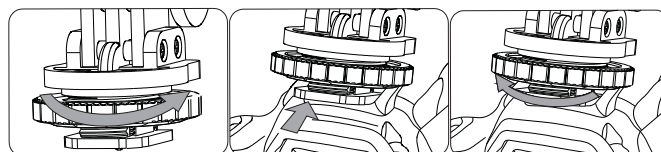

- ① Screw the hot shoe fastening knob to the top in the direction of the arrow.
- ② Insert the lamp into the camera/camera hot shoe base in the direction of the arrow.
- ③ Tighten up the hot shoe knob in the direction of arrow.

b. Place it on the desktop or on a plane, and use it with the miniature stand attached.

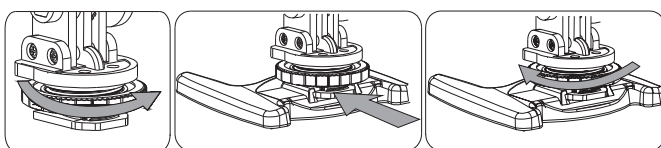

- ① Rotate the hot-shoe lock knob to the top in the direction of the arrow.
- ② Push the metal hot-shoe on the lamp foot in the miniature stand in the direction of the arrow.
- ③ Screw up the hot-shoe lock knob in the direction of the arrow.

c. Fix on the Tripod

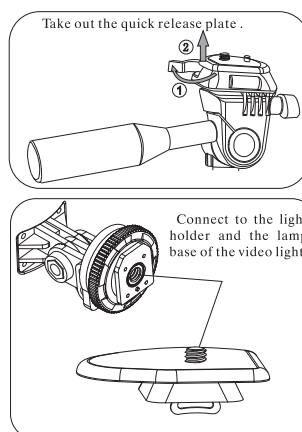

Fasten the camera lamp to the tripod.

d.Fasten the video light to the handle attached

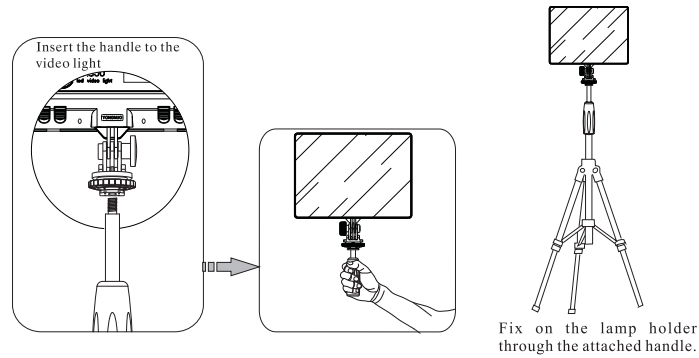

4.Switch and brightness adjustment

a. Press the power switch and light the LED video light. Rightwards rotate to increase the brightness, or leftwards rotate to reduce the brightness;

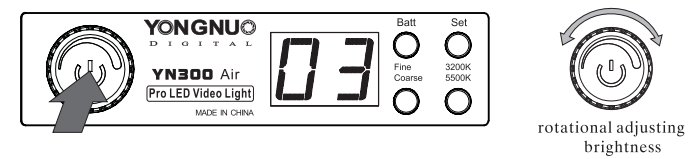

b. Fine/Coarse Button

It is divided into Fine/Coarse adjusting mode,with more convenient use. Press the Fine/Coarse button to Fine/Coarse adjusting switch.When the Coarse indicator light on,it will enter into Coarse adjusting mode,the brightness is 10% as an adjustment unit.Another press will switch to Fine adjusting mode and the brightness is 1% as an adjustment unit.

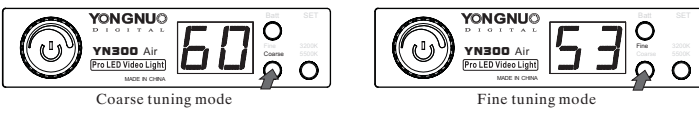

5. Color temperature Adjustment

Press the 3200K/5500K button to switch the color temperature,the color temperature can be adjusted from 3200-5500K as needed. Press the button till the indicator light bright on the 3200k,rotate the luminance adjustment knob to adjust the light of 3200K color temperature;Then press the button till the indicator light bright on the 5500k, rotate the luminance adjustment knob to adjust the light of 5500K color temperature.

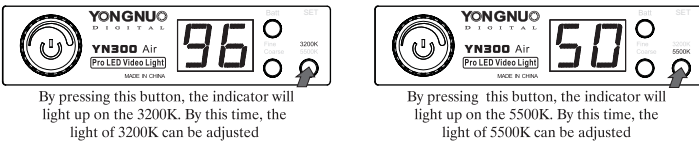

6.Test of Electric Quantity

Press [Batt] the electric quantity testing button, the reading shows the percentage of the remaining battery power of the batteries. The readings can be divided into P0-P9, which indicates 0%-90% of the electric quantity. For example, the reading P3 as the picture shown indicates the electric quantity is 30% (Note: the power test with low luminance is different from that with high luminance, thus the service time is based on the current luminance.)



7.Memory Button

a.After the video light adjusted to the luminance and color temperature as you need, long press the SET button until the digital tube blink twice,then the setup will be save successfully. You just need to short press the SET button when you need to adjust the video light and restore the previous settings.
b.Long press the SET button to update the save settings.



8. External Power Supply

It is recommended to use YONGNUO power adapter with YN300 Air to obtain lasting service time. When using external power supply, the video light will stop the battery power supply automatically and will not get the battery charged. The external power supply interface outside is positive and the interface inside is negative. The input voltage is 8V and the electric current is 5A.Note: If YN300 Air defective when it is used with power adapter of other brands, YN300 Air will no longer be guaranteed for repair.

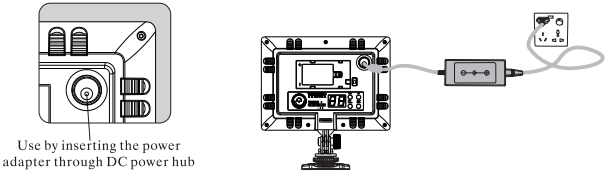

IV. Product Specification

Light Source	96 LED beads	Luminance Angle	110°
Color Temperature	3200K-5500K	Color Rendering Index	Greater than to 95
Output power	18W	Weight	500g
Lumen	2000 LM	Gift box size	210*175*62mm
Average Service Life	50000H	Power Supply	A lithium battery /the external 8V,5A DC power .
Contents: Video light(1),Handle(1),User manual(1) ,Light base(1),Micro base(1) Note: Please contact your dealer if anything missing.			

V. Failure Analysis and Troubleshooting

When using this product, you may encounter the following problems:

Description	Cause	Troubleshooting
No reaction after power on	Low Battery	Install new batteries or connect external power supply
	Damaged circuit board	Depot repair
Inadequate or low luminance at the greatest luminous intensity	Low battery	Install new batteries or re-charge the batteries
Inaccurate battery capacity test: low battery in high luminance and full battery in low luminance.	The battery capacity indicates the length of time available for the use in the current luminance. Higher luminance required more power and the length of time available for use will be shortened, so the battery capacity shown gets lower	Normal phenomenon and no measure needed

Dealer: SHENZHEN YONGNUO PHOTOGRAPHY EQUIPMENT Co., Ltd
Add: 2-B509 Saige Science & Technology Park, North Huaqiang Rd, Futian District, Shenzhen, China
TEL: 0755-8376 2448
FAX: 0755-8376 2765
Web: www.hkyongnuo.com
Manufacturer: SHENZHEN YONGNUO ELECTRIC APPLIANCE Co., Ltd
Add: NO.1 Workshop, Tong Le Wen Hao Industrial Factory District, Longgang Sub-district, Longgang District, Shenzhen, China
TEL: 0755-8480 8443
After-sales Service TEL: 400-0013-888